

# SILENT HITCH PIN™

ANTI-RATTLE, ANTI-VIBRATION  
DEVICE FOR TOTAL STABILITY™



Best market accepted solution for hitch receiver and towing stability.

This patented technology takes all the movement out of the connection between the vehicle towing system and what's being towed. Keeps hollow ball mounts, cargo carriers, and other tow accessories secure and rattle-free.

- Works with all Class II, III/IV hitches with 2" receiver tubes.
- Hitch accessory shank must be hollow.

## Locking Silent Hitch Pin, Class IV w/ Barrel Lock

Chrome coating, heavy-duty spring nut with counter boring, sleeve, rubber dust cap on lock. Clamshell packaged for retail display.



Installation is easy!

1. Insert spring nut into ball mount or accessory shank
2. Insert accessory device into receiver
3. Insert Silent Hitch Pin, sleeve, tighten firmly with wrench.
4. Apply lock.



*The result is silence.*

U.S. Patent No: 6,409,203;  
6,609,725; 6,945,550; 6,910,609



*Installing Silent Hitch Pins in my tow bar was the best thing I could have done to eliminate the movement and resulting excessive wear in the tow bar/receiver connection. I use a Blue Ox Aladdin aluminum tow bar. The holes in the hitch connector were elongating very rapidly. I installed*

*the Silent Hitch Pin two years ago and the wear has stopped. I wouldn't be without them.*

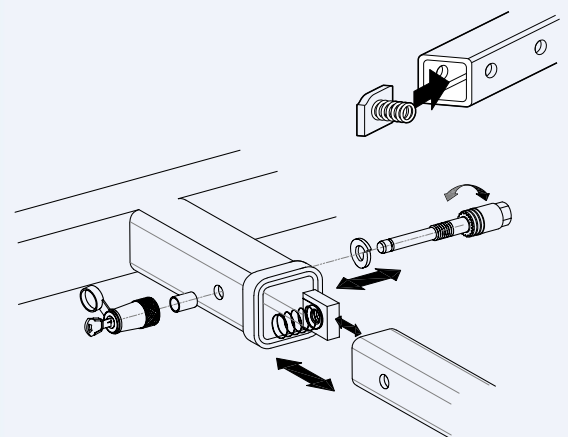

**For More Information and To Order:**

**877-GO-4-AERO (464-2376)**

**www.LetsGoAero.com**

**LET'S GO AERO**  
Gear Management Solutions™